

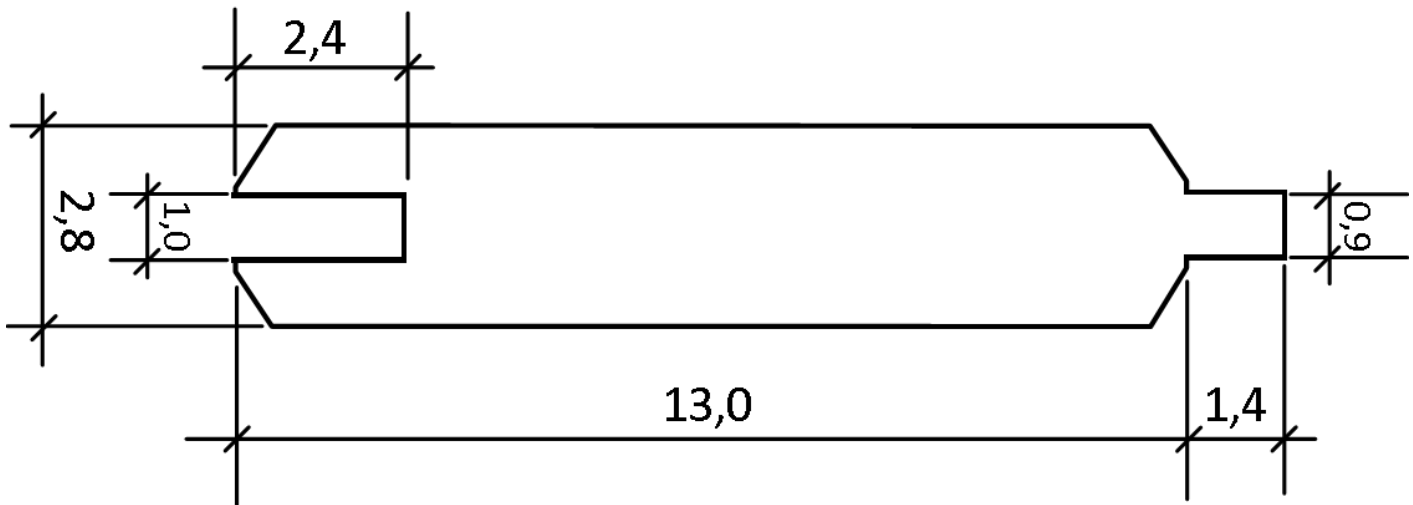

CONSTRUCTION DIAGRAMS OF A PHOTO HIDE



Cross section of grooved board



BRAKE DOWN OF THE SUPPLIES

Item	Dimensions H x l x L in cm	Quantity	Price per item	Total price	Remarks
WOOD					
Grooved boards	2,8x14,5x240	12	9,24	110,88	Hide walls (1)
	2,8x14,5x180	20	7,09	141,80	Hide walls (2)
Poles	7,0x7,0x180	4	10,29	41,16	Hide corners reinforcement
Cleats—rafter	5,4x3,5x180	4	10,39	41,56	Door and windows openings frames
	5,5x3,5x180	3	10,50	31,50	Roof frames
	4,2x1,2x210	5	5,49	27,45	Door and windows exterior frames
	2,7x1,2x210	3	5,09	15,27	Door and windows interior frames
	9,2x1,2x210	4	9,39	37,56	Roof borders
	0,7x0,7x120	1	3,05	3,05	Support for back door window plexiglass
Boards	19,0x1,8x210	8	22,87	182,96	Roof
TOTAL WOOD				633,19	
OTHER SUPPLIES					
Roofing	6mx1m	1	112,00	112,00	Roof cover and waterproofing
Plexiglas	50,0x50,0x0,3	1	18,59	18,59	Back door window
TOTAL OTHER SUPPLIES				130,59	
HARDWARE					
Hinges		5	3,69	18,45	Door and windows hinges - Need 9 - Sold per 2
Small locks		2	6,10	12,20	Windows locking - Need 4 - Sold per 2
Brass locks		2	5,49	10,98	Back door locking
Lag screws	8x60 mm	1	8,49	8,49	Fixing of walls to corner reinforcement - Need 8 - Sold per 18
Screws	PZ2 40x3,5 mm	1	6,19	6,19	Fixing door and windows frames - 200 ea
	PZ2 50x4,0 mm	1	9,49	9,49	Fixing roof onto roof frames- 200 ea
TOTAL HARDWARE				65,80	
OVERALL TOTAL				829,58	

(1) Will be used to cut 10 boards of 145,6 cm
20 boards of 45,3 cm
8 boards of 57,8 cm

⑧ ⑩ ⑪ ⑫
④
⑨

(2) Will be used to cut 8 boards of 145,6 cm
12 boards of 175,6 cm

⑧ ⑩ ⑪ ⑫
① ② ③ ⑤ ⑥

General cutting of the grooved boards

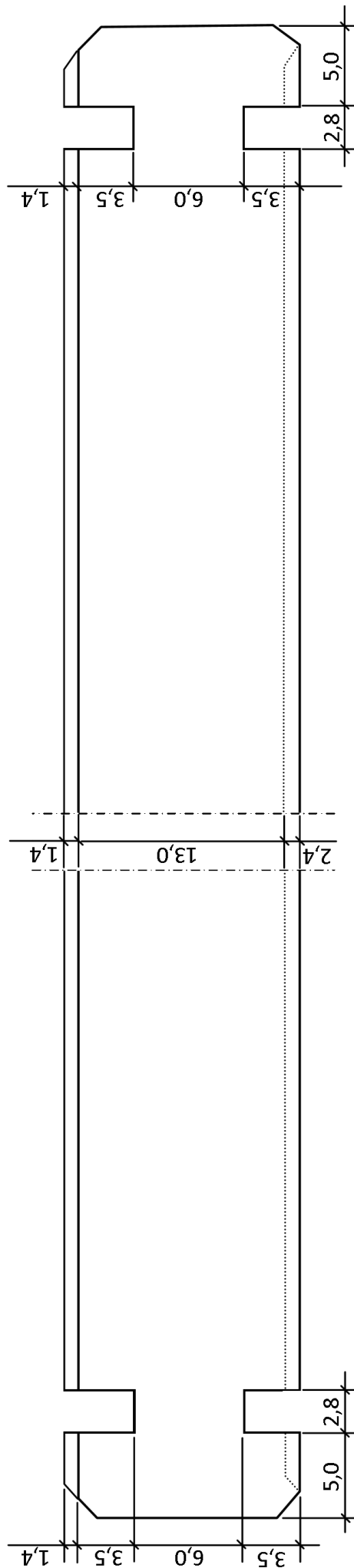

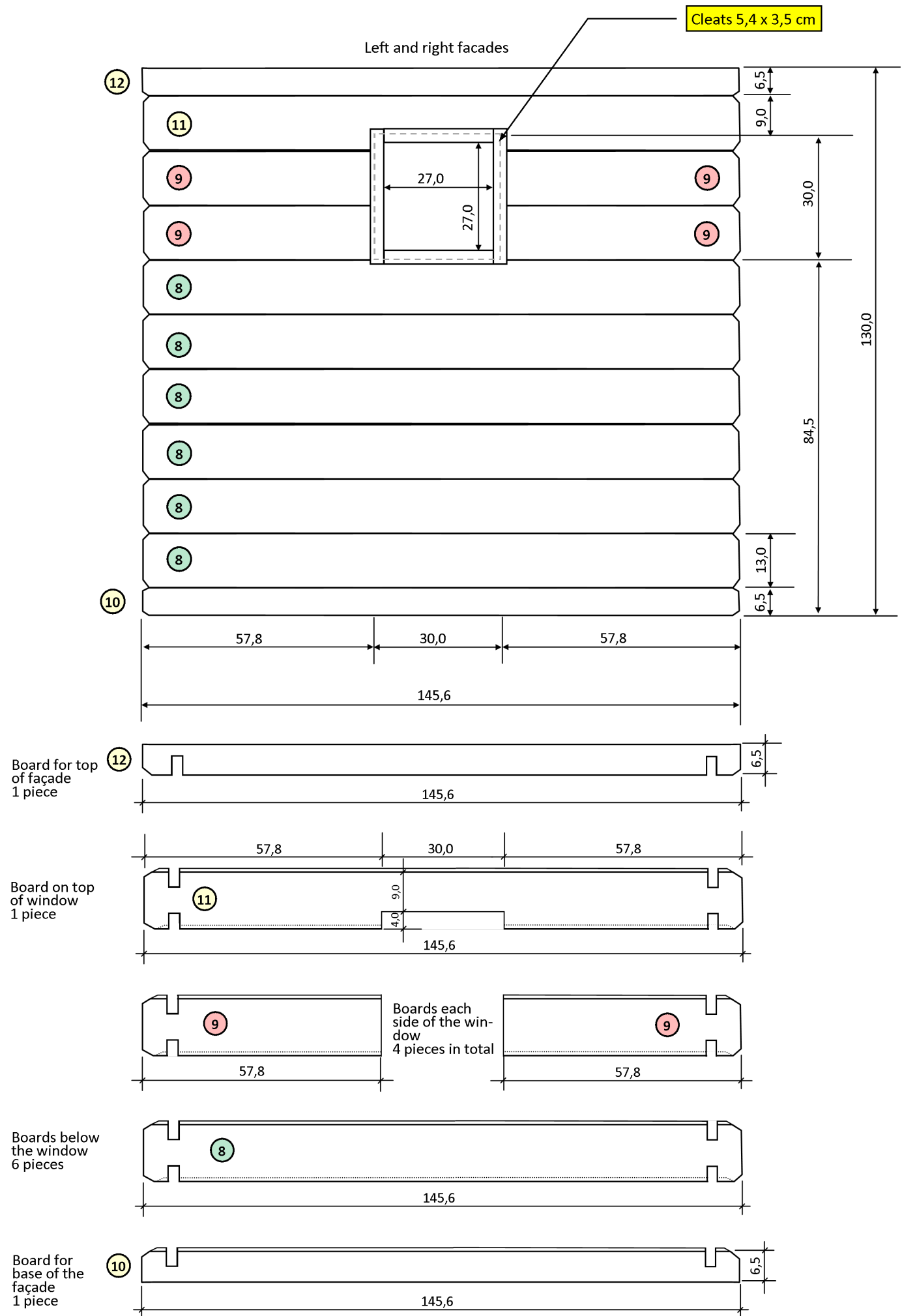

Cross section and cutting of roof frames

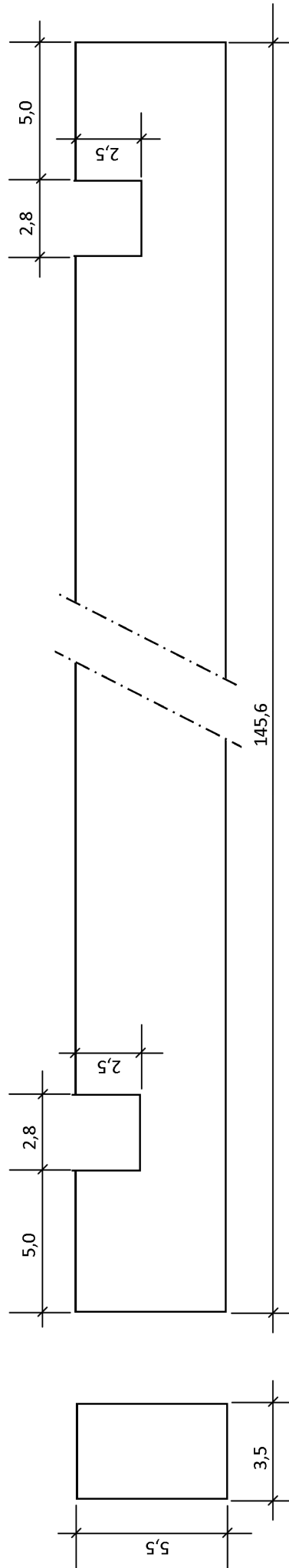

Door and window frame
cross section
cleat 5,4x3,5x180 cm

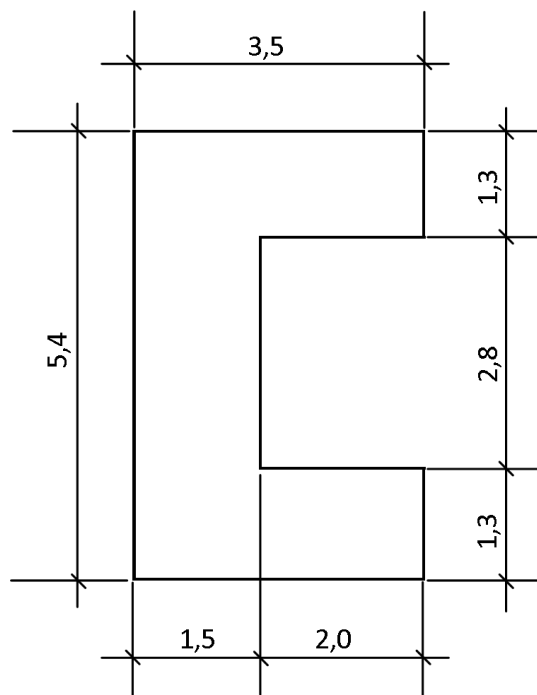

Door and window frame
cutting

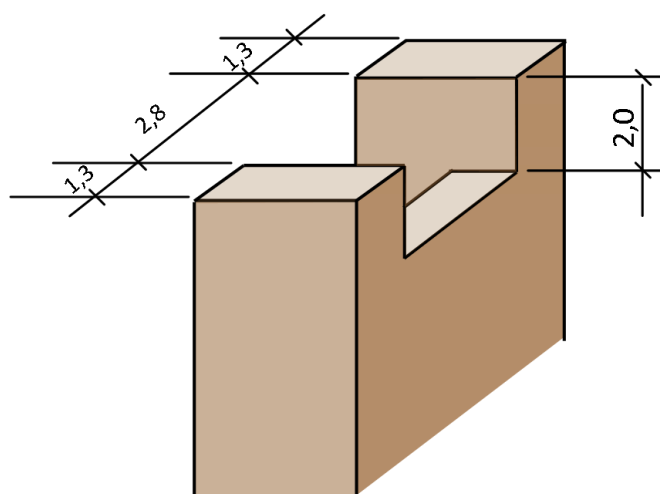

Door and window frame assembly



Technical drawing of a cabinet showing dimensions and components.

Dimensions:

- Overall width: 113.5 cm
- Overall depth: 83.4 cm
- Internal width (excluding side panels): 108.1 cm
- Internal depth (excluding top and bottom panels): 75.0 cm
- Side panel width: 4.2 cm
- Top panel width: 4.1 cm
- Bottom panel width: 4.1 cm
- Door width: 78.0 cm
- Door height: 78.0 cm
- Door panel width: 13.0 cm (8 panels)
- Door panel height: 13.0 cm (8 panels)
- Door panel thickness: 1.2 cm
- Door panel gap: 1.5 cm

Components:

- Cleats 4,2x1,2 cm (Side panels)
- Cleats 2,7x1,2 cm (Top and bottom panels)
- Grooved boards (Door panels)
- Voir détail (Detail view of the door)

Detail door window

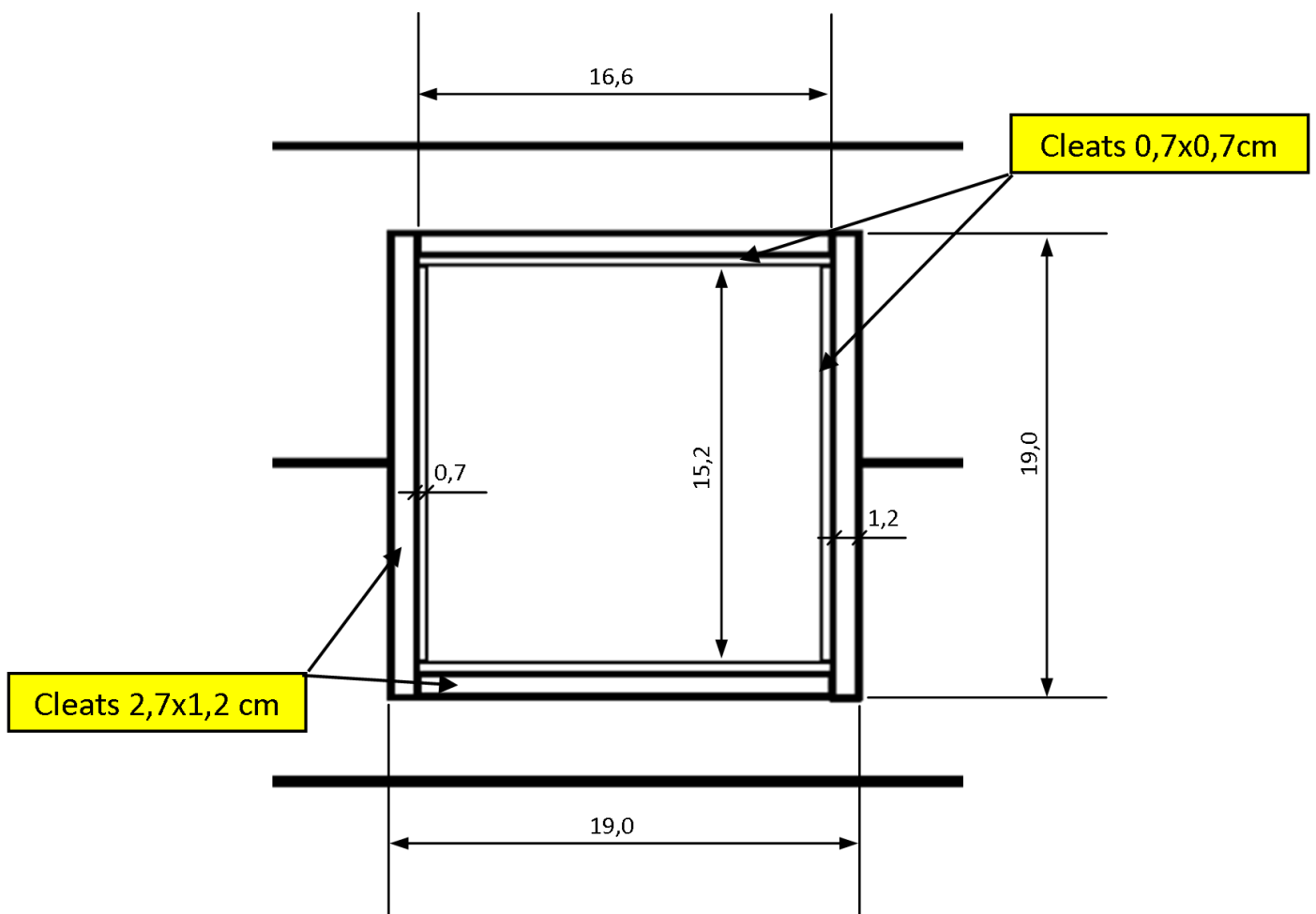

Detail of the observation window on the front façade

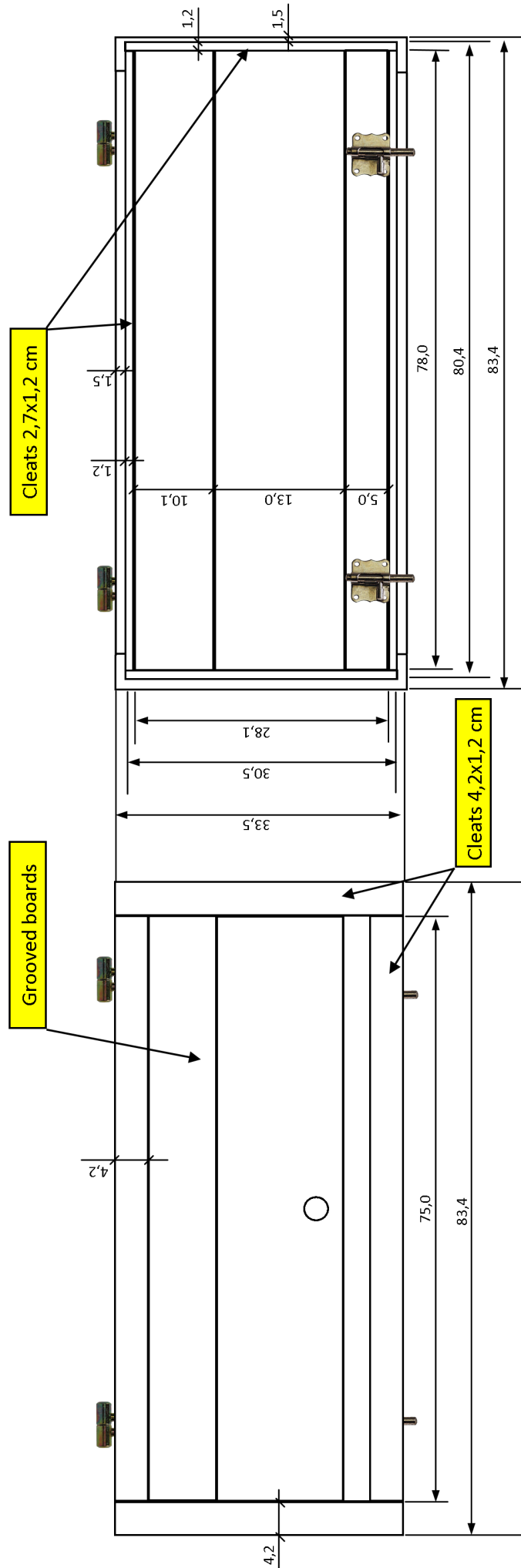

Detail of the windows on the left and right facades

